



**Better Housing
Better Health**

Suite 2, Challenge House
15 Sherwood Drive
Milton Keynes, MK3 6DP
bhbh@nef.org.uk
0800 107 0044

**SELECTED KINGSWOOD ESTATE
ADDRESSES – see area map**

August 2020

Dear Resident

Government announces 'Green Homes Grant'

In September households will be able to claim a voucher for insulation on a first come first served basis. **£5,000 grants (and up to £10,000 for low income households) will be available to make your home warmer and more efficient.**

Be ready to claim your voucher with a free energy survey of your home. The council has teamed up with Better Housing, Better Health to offer the **first 100 residents a free Energy Performance Certificate (EPC) and home energy survey worth over £70!**

The survey will identify the suitability for your home to be upgraded, so that you will be ready to claim your government voucher when the scheme opens in September.

You could also have the chance to enter our competition for **one lucky household to have completely FREE external wall insulation fitted.** As part of the survey we are working in your area to identify suitable properties for external wall insulation. 100's of properties over Watford have already benefitted and we are now offering installs in your selected area. **External wall insulation could save you up to £225.00 every year on your energy bills, improve the home's value, help keep you warm in your home and help towards cutting CO2 emissions.***

So if you own or rent your home privately, you can take advantage of this scheme. This is a time limited offer available on a first come first served basis to residents in a selected area who receive this letter. If you have any questions or want more information then please don't hesitate to call us on **0800 107 0044** (phone line open Monday – Friday excluding bank holidays). Other types of insulation upgrades as well as advice and fuel switching are also available from the Better Housing Better Health team. We look forward to hearing from you soon.

Yours Sincerely

The Better Housing Better Health team



over/

What is an EPC?

Much like the multi-coloured sticker on new appliances, EPCs tell you how energy efficient a building is. They will also state what the energy-efficiency rating could be if you made the recommended improvements, and highlights cost-effective ways to achieve a better rating.



What is External wall insulation?

A layer of insulation material is fixed to the wall, then covered with a special type of render (plasterwork) or cladding. The finish can be smooth, textured, painted, tiled, panelled, pebble-dashed, or finished with brick.

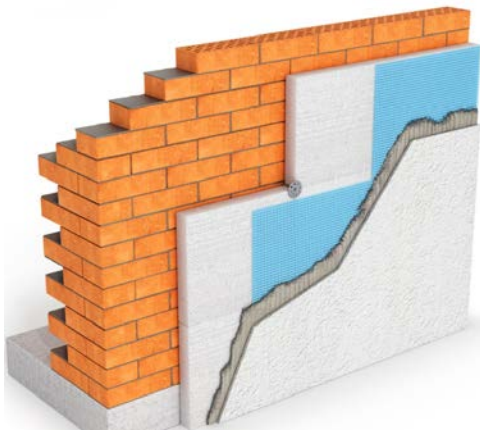

This is an example of an insulated Watford property that used a combination of smooth render with a brick finish.

* The Energy Savings Trust estimates typical savings for a semi-detached property of £225 per year from your heating bills and savings of 930 kg of Carbon dioxide every year.

You can e-mail **Better Housing Better Health** to register your interest bhbh@nef.org.uk, phone them on 0800 107 0044, complete your referral online at <http://www.bhbh.org.uk/make-a-referral/> OR alternatively return this completed form to **Better Housing Better Health, Suite 2, Challenge House, 15 Sherwood Drive, Milton Keynes, MK3 6DP**. Please ensure you leave us all your details so that we can get in touch to make arrangements with you for the free no obligation assessment where we will be able to answer any questions.

First name:	Surname:
Address:	
Post code:	
Contact telephone number:	
E-Mail address:	

During your survey, suitable homes will be able to register to be entered into the prize draw to win free external wall insulation (terms/conditions apply and will be made available during your survey).