



**Better Housing
Better Health**

Suite 2, Challenge House
15 Sherwood Drive
Milton Keynes, MK3 6DP
bhbh@nef.org.uk
0800 038 6030

SELECTED West Watford area –

<https://www.watford.gov.uk/westwatford>

July 2021

Dear Resident

Energy Efficiency Funding

We are delighted to offer eligible residents in the area grants and loans for selected insulation and energy measures. Have you been cold this winter? Worried about your bills or want to make a difference to your carbon emissions?

Selected homes in your street can now benefit from measures such as external wall insulation, underfloor and roof insulation or solar panels. There are also grants for smart heating controls.

Government Green Homes Grants, Energy company obligation and Watford Borough Council grants and loans are available to you. Different grants range from **£100 to over £10,000 for selected homes to make your home warmer and more efficient.**

If your household income is near to or below £30,000 works maybe **fully funded**, but otherwise grants and interest free loans are also available. The council has teamed up with Better Housing, Better Health to offer free no obligation energy survey to identify options for your home.

So if you OWN or RENT your home privately, you can take advantage of this scheme. This is a time limited offer available on a first come first served basis to residents in the selected area who receive this letter. If you have any questions or want more information then please don't hesitate to call us on **0800 038 6030** (phone line open Monday – Friday excluding bank holidays). Other types of insulation upgrades as well as advice and fuel switching are also available from the Better Housing Better Health team. We look forward to hearing from you soon.

Yours Sincerely

The Better Housing Better Health team

See <https://www.watford.gov.uk/carbon-assistance> for more information.



over/

What is External wall insulation?

A layer of insulation material is fixed to the wall, then covered with a special type of render (plasterwork) or cladding. The finish can be smooth, textured, painted, tiled, panelled, pebble-dashed, or finished with brick to replicate your existing homes finish.

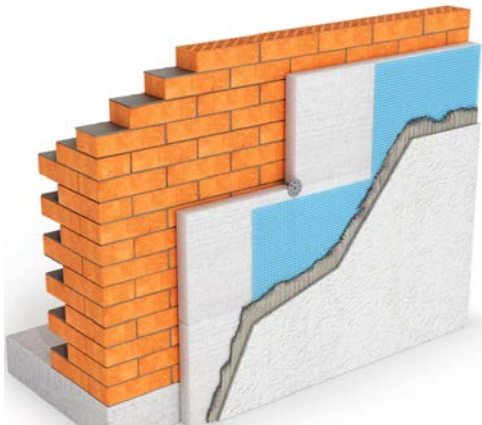

This is an example of an insulated Watford property that used a combination of smooth render with a brick finish.

* The Energy Savings Trust estimates typical savings for a semi-detached property of £225 per year from your heating bills and savings of 930 kg of Carbon dioxide every year.

What is Solar PV?

Solar photo-voltaic, also known as Solar Panels, give you a consistent stable form of power when the sun is shining. Solar Panels are attached to the roof of your home and generate a direct current of electricity. This is then passed through an inverter, which converts it into an alternating current which can be used in your home.



You can e-mail Better Housing Better Health to register your interest bhbh@nef.org.uk, phone them on 0800 107 0044, complete your referral online at <http://www.bhbh.org.uk/make-a-referral/> OR alternatively return this completed form to **Better Housing Better Health, Suite 2.15, Challenge House, Sherwood Drive, Milton Keynes, MK3 6DP. Please ensure you leave us all your details so that we can get in touch to make arrangements with you for the free no obligation assessment where we will be able to answer any questions.**

First name:	Surname:
Address:	
Post code:	
Contact telephone number:	
E-Mail address:	